

SPECIFICATIONS

Model	A1 1"		A1 2"	A1X 1"	A1X 2"
Laser Plummet - AutoHI					
Type	Class II red laser				
Measuring Range	-		0.6-2.0m		
Minimum Reading	-		1mm		
Distance Accuracy	-		3mm		
Deviation	-		0.4mm @ 1.5m height		
Spot Diameter	-		1.5mm @ 1.5m height		
Distance Measurement (Reflector)					
Range	Single : 5000m				
	Triple : 1000m				
	Sheet : 1000m				
Accuracy	±(1+1×10 ⁻⁶ ·D)mm	±(2+2×10 ⁻⁶ ·D)mm	±(1+1×10 ⁻⁶ ·D)mm	±(2+2×10 ⁻⁶ ·D)mm	
Measure Time	Fine: 0.3s,Tracking: 0.2s,Normal: 0.2s				
Distance Measurement (Reflectorless)					
Range (Kodak Standard Gray, 90% Diffuse Reflectance)*	1000m				
Accuracy	0-300m 3+2		300-600m 5+2	>600m 10+2	
Measure Time	Fine: 0.3s,Tracking: 0.2s,Normal: 0.2s				
Angle Measurement					
Detection Method	Absolute Encoding				
Diameter of Encoding Disk	79mm				
Min. Reading	0.1"	1"		0.1"	1"
Accuracy	1" /2"			1" /2"	
Telescope					
Image	Erect				
Tube Length	154mm				
Effective Aperture	Effective: 45mm DTM: 50mm				
Magnification	30X				
Field of View	1°30'				
Resolution	3"				
Min. Focusing Range	1.5m				
Guide Light					
Type	-		Red+yellow flashing LEDs		
Working Range	-		150m		
Comprehensive parameter					
Sensor	Dual-axis Liquid-Electric Sensor (Range: ±6', Accuracy: 1")				
Atmospheric Correction	T-P Sensor Auto Correction				
Prsim Constant	Auto Correction				
Trigger	Under Battery House				
IP Standard	IP55				
Vial					
Plate Vial	30"/2mm				
Circular Vial	8'/2mm				
Plummet	Laser Plummet (Optical Optional)			-	
Data Transfer	RS-232C, USB, BLUETOOTH, Flash Disk				
Display Unit					
Type	LCD, Graphic				
Size	5.0 Inch				
Graphic Display	Max: 99999999.999	Min: 0.1mm (1")	Max: 99999999.999	Min:1mm (2")	
Battery					
Power Supply	Lithium Battery 5000mAh				
Voltage	7.4V				
Working Hours	10 Hours				
Dimention And Weight					
Dimention	206x200x353mm				
Weight	6kg				
Storage					
ROM	32GB				
RAM	3GB				
Function					
GPS	Available				
Voice Recording	Available				
CPU	mt6735				
Data And Network					
Data Transfer	BLUETOOTH, Wifi, Wifi Hotspot				
4G	Available				
3G/2G	Available				
System Version	ANDROID 9				

*© South Surveying & Mapping Technology CO.,LTD All Rights Reserved

A1 series
Android Total Station

“possibility

infinite”





Features



The first Android Total Station **A1 series** features open interface, available for any 3rd party software
Available for customized software based on your own request
5.0 Inch capacitive screen with multi-touch technology, quick and smooth for operations.

Hardware

Intergrated CPU



Fast
MTK MT6735 4-core processor boosts speed, responsiveness and performance
64 digits Cortex-A53 MPCORE TM structure, in 1.3GHz frequency



Enhanced algorithm
Powerful GPU with MALIT720-MP2 3D processor

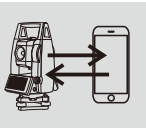

Multiple Transfer
Standard Bluetooth, WIFI, Hotspot, RS232C, USB connection

Structure Improved



Stable: Horizontal co-axis, improved the stability of accuracy
Dual-Compensator: Re-located at the vertical center

Software

simple but not simplistic

Professional Framing

Iconic user interface, offers a smooth and flashing working experience.
Behind every simple step on A1 is our unremitting efforts to optimized the algorithm.

Built-in Toolbar, Quicker Than Ever

Integrate the setting page of laser pointer and plummet switch into quick menu.
The switching of measure mode, target and sensor becomes quicker to activate in toolbar than the other models.

Stake-out Guidance

Compass pointer with stake-out sketch, driving the new premium extras and powerful tools for your job.
A1 considered all the possible request by summing up the user's feedback over the years.

Automatic Graph Drawing

The graphic drawing in A1 realizes the data viewing and outputs in real-time.
Precision designed down to the last pixel in all conditions.

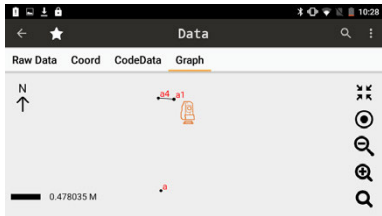
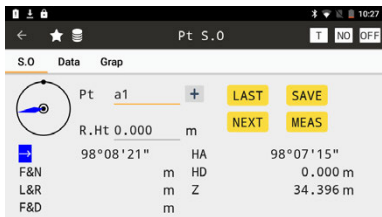
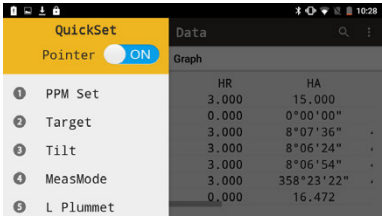
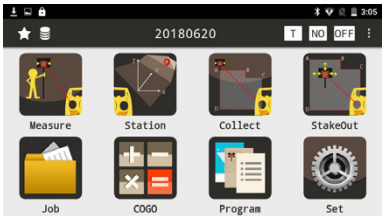

Functions

